

Level 3 Floor Load:  
125 lbs per square Foot

### West Level Three

Level Three Lobby

Patio

Open to below

Open to below

Note: wall protrudes out 3 when combined

Note: wall protrudes out 3 when combined

Note: wall protrudes out 3 when combined

Note: wall protrudes out 3 when combined

Note: third door

Note: third door

Note: third door

Skyfold Door

Skyfold Door

Skyfold Door

Skyfold Door

Skyfold Door

**Disclaimer:**  
This drawing is intended as a guide only. The Moscone Center/SMG cannot be held responsible for on-site variations or adjustments.  
04.30.2024

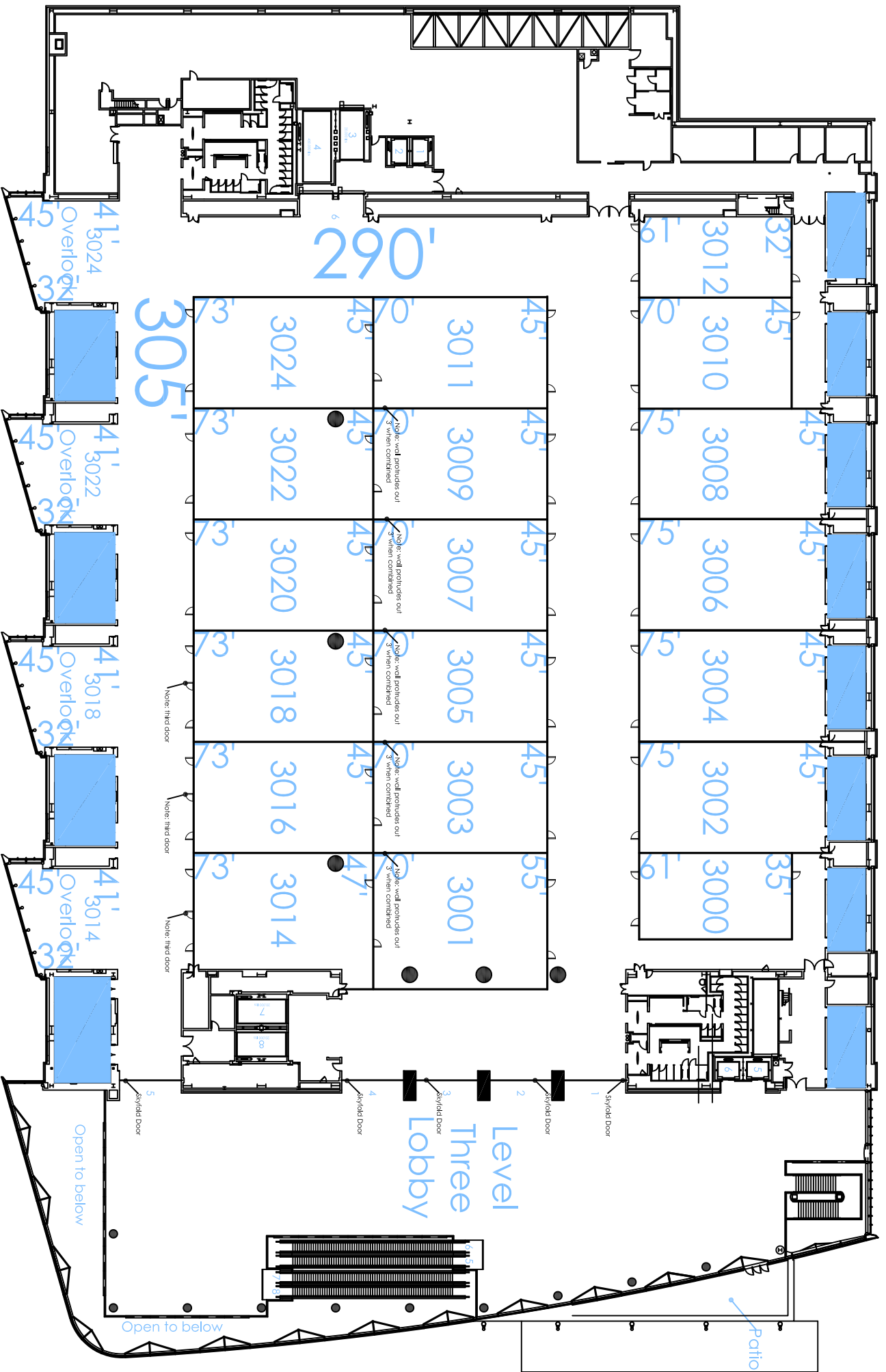

West Level Three  
Level Three | Dimensions

**Disclaimer:**  
This drawing is intended as a guide only. The Moscone Center/SMG cannot be held responsible for on-site variations or adjustments.  
04 30 2024

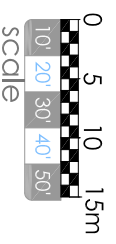
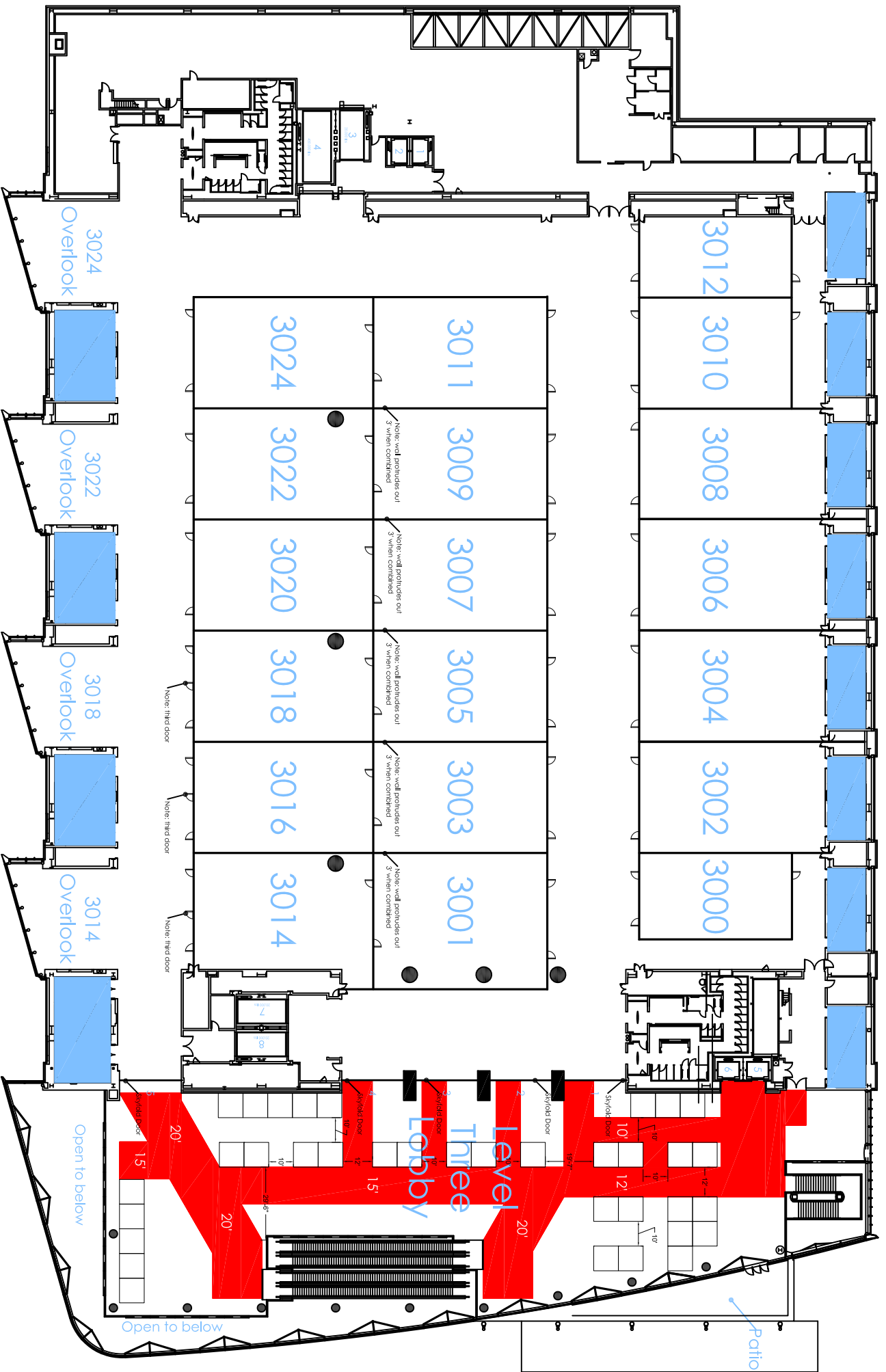

Level 3 Floor Load:  
125 lbs per square Foot

West Level Three  
Booths

**Disclaimer:**  
This drawing is intended as a guide only.  
The Moscone Center/SMCG cannot be held  
responsible for on-site variations or  
adjustments.  
04/30/2024



# West Level Three

## Utilities

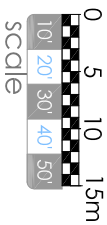

Level 3 Floor Load:  
125 lbs per square Foot

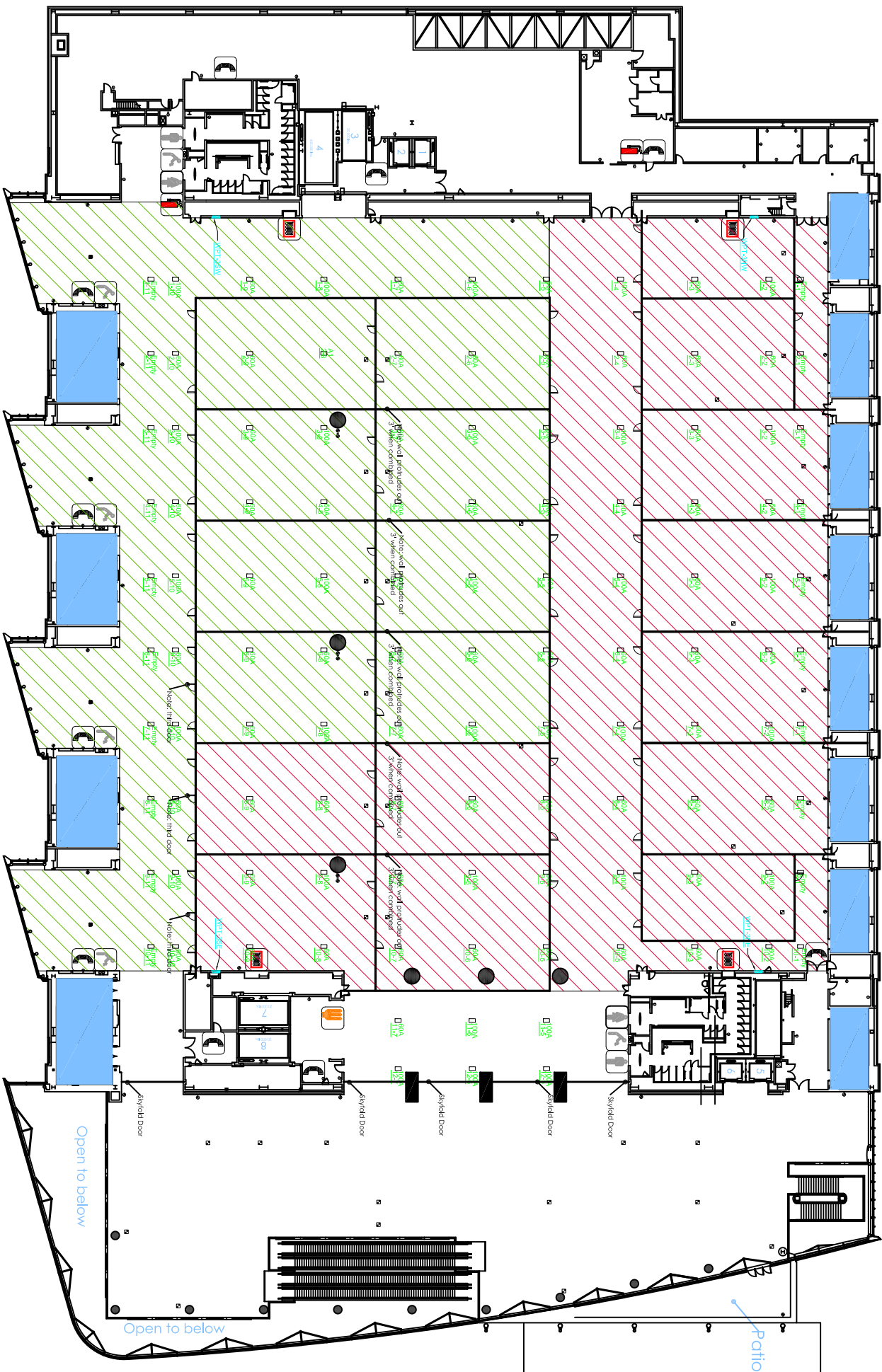

	Overlook Floor Outlet		Ductile Floor Outlet		20 Amp Outlet		250 Amp Disconnector @ 480 Vols
	Floor Port		20 Amp Outlet		250 Amp Disconnector @ 480 Vols		HVAC system 1
			HVAC system 2				

utilities

	Fire Alarm		Exit Sign		No Smoking		No Open Flame
	No Smoking		No Open Flame		No Parking		No Standing
	No Parking		No Standing		No Entry		No Pedestrian
	No Pedestrian		No Vehicle		No Bicycles		No Skateboards
	No Bicycles		No Skateboards		No Roller Skating		No Roller Skating

sign-safety sign-wayfinding

**Disclaimer:**  
This drawing is intended as a guide only. The Moscorne Center/SMG cannot be held responsible for on-site variations or adjustments.  
04/30/2024



# West Level Three

## Level Three | Rig Points

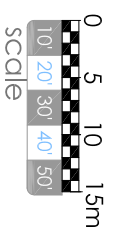

Level 3 Floor Load:  
125 lbs per square foot

Contact Event Manager or Theatrical Services for hanging points.

Contact Event Manager or Theatrical Services for hanging points.

Contact Event Manager or Theatrical Services for hanging points.

Contact Event Manager or Theatrical Services for hanging points.

Contact Event Manager or Theatrical Services for hanging points.

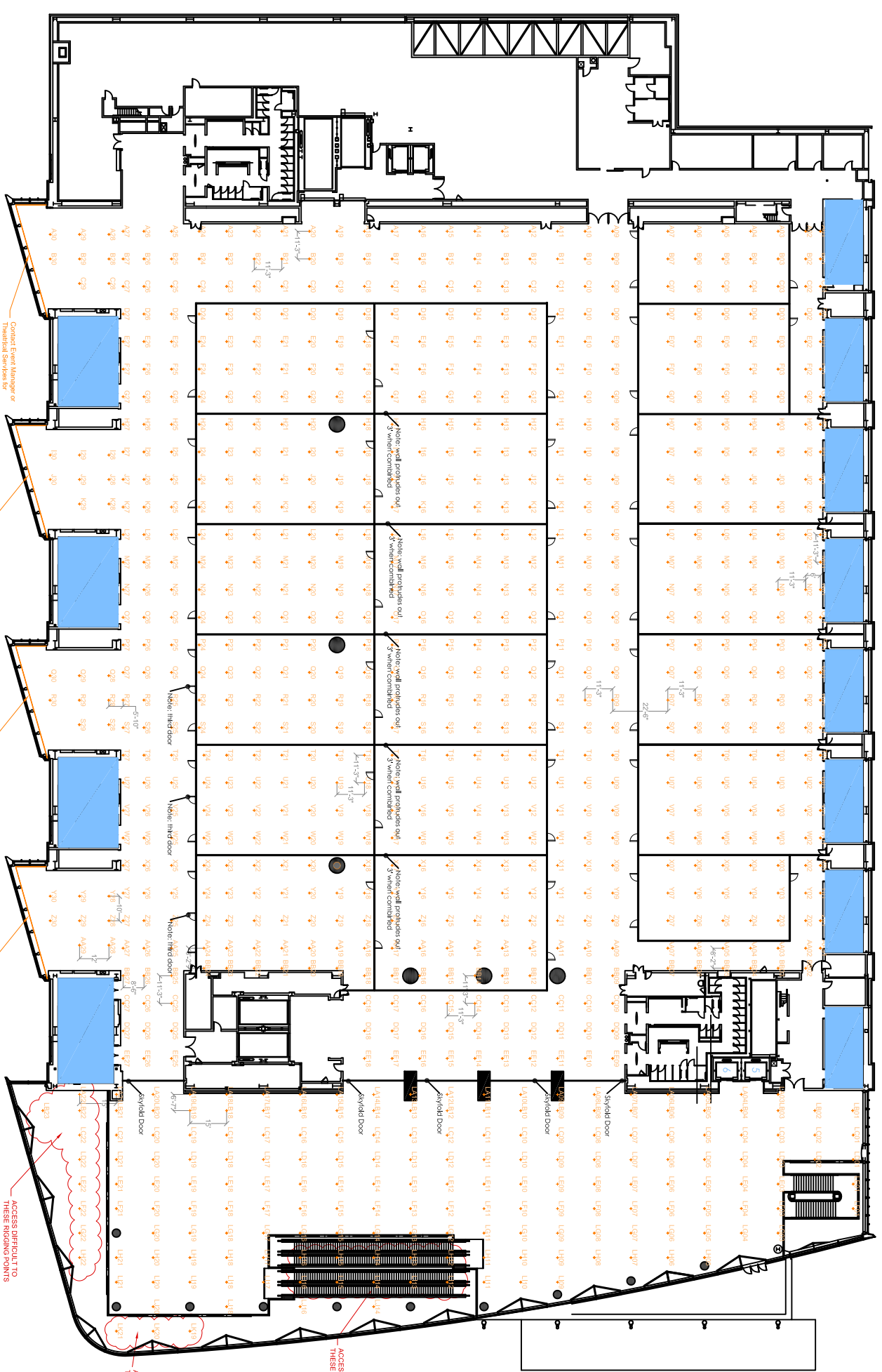

NOTES:  
-RIGGING EYEBOOLT POINTS ARE RATED AT 2000LBS IN ANY DIRECTION. DOOR TO CEILING = 27" HEIGHT FROM FLOOR TO BOTTOM OF EYEBOOLT = 288"

### - RIGGING EYEBOOLT #  
- RIGGING EYEBOOLT POINT

⊘ RIGGING POINT UNDER REPAIR

**rig points**

**Disclaimer:**  
This drawing is intended as a guide only. The Moscone Center/SMG cannot be held responsible for on-site variations or adjustments.

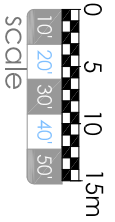
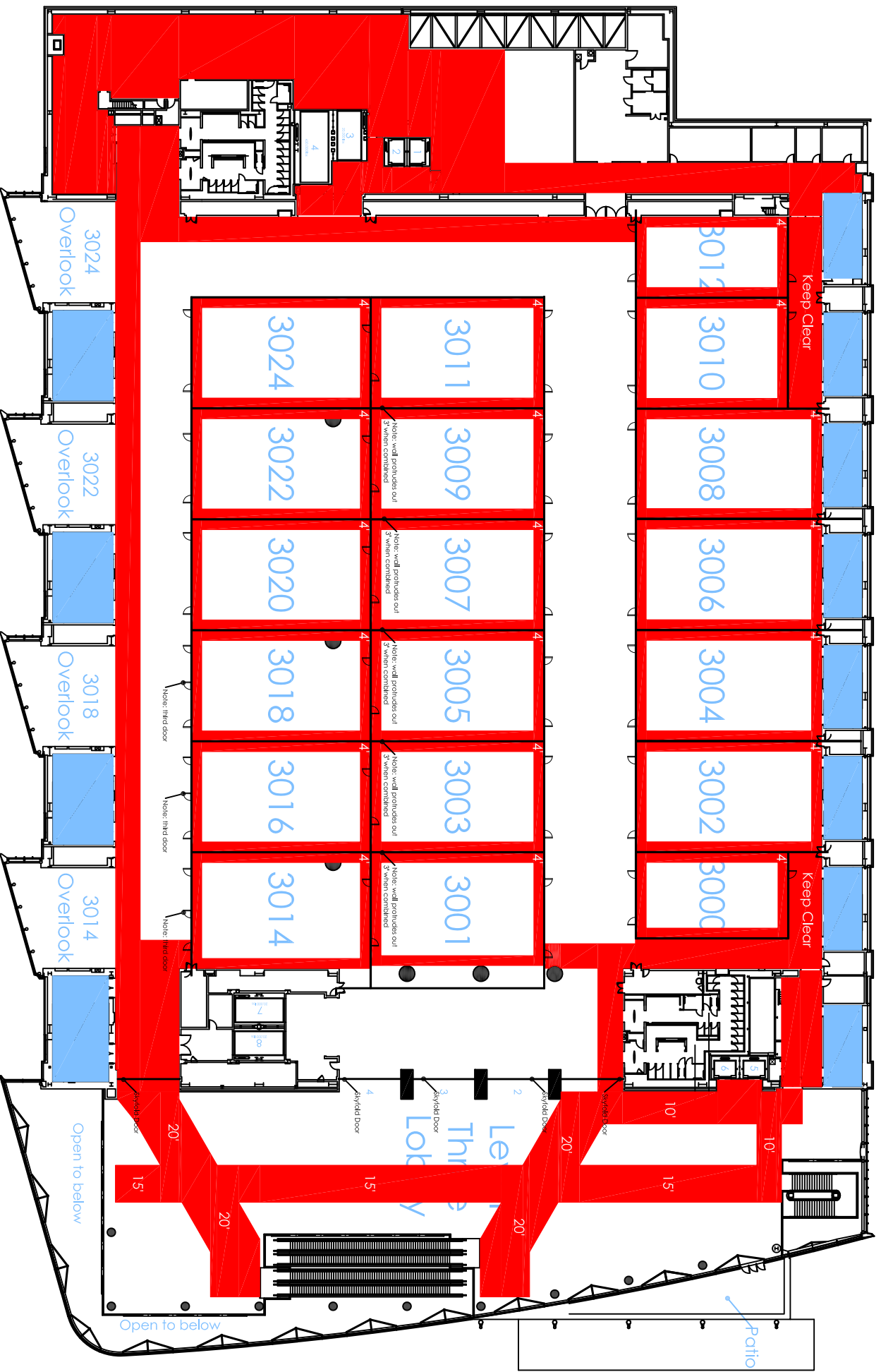

Level 3 Floor Load:  
125 lbs per square Foot

West Level Three  
Keep Clear

**Disclaimer:**  
This drawing is intended as a guide only.  
The Moscone Center/SMG cannot be held  
responsible for on-site variations or  
adjustments.  
04/30/2024



West Level Three  
Level Three | Air Wall Movement

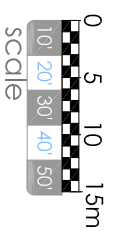

Level 3 Floor Load:  
125 lbs per square Foot

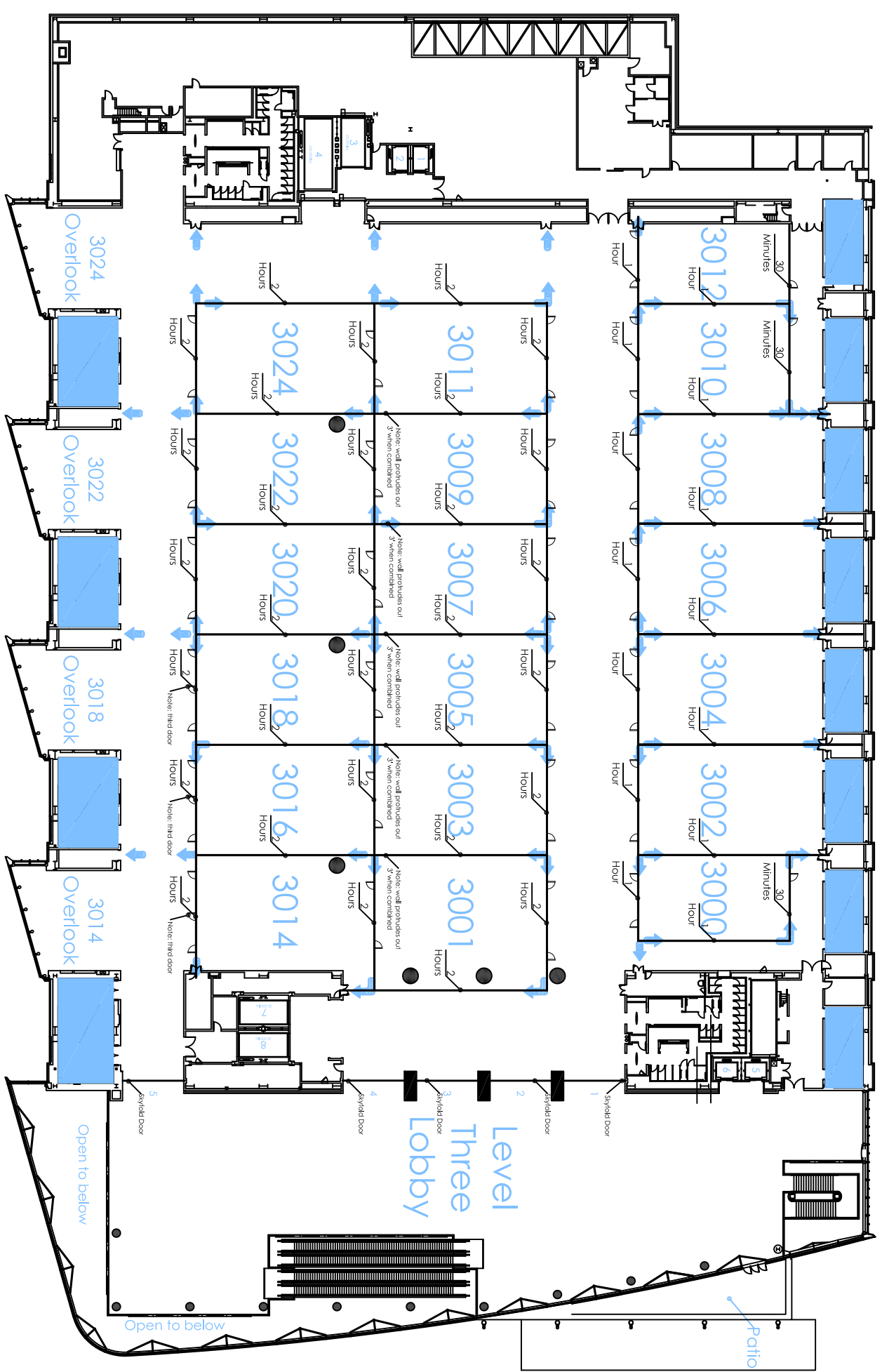

**Disclaimer:**  
This drawing is intended as a guide only.  
The Moscone Center/SMG cannot be held  
responsible for on-site variations or  
adjustments.  
04 30 2024





# West Level Three Theater

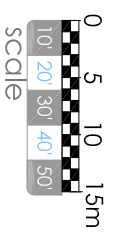

Level 3 Floor Load:  
125 lbs per square Foot

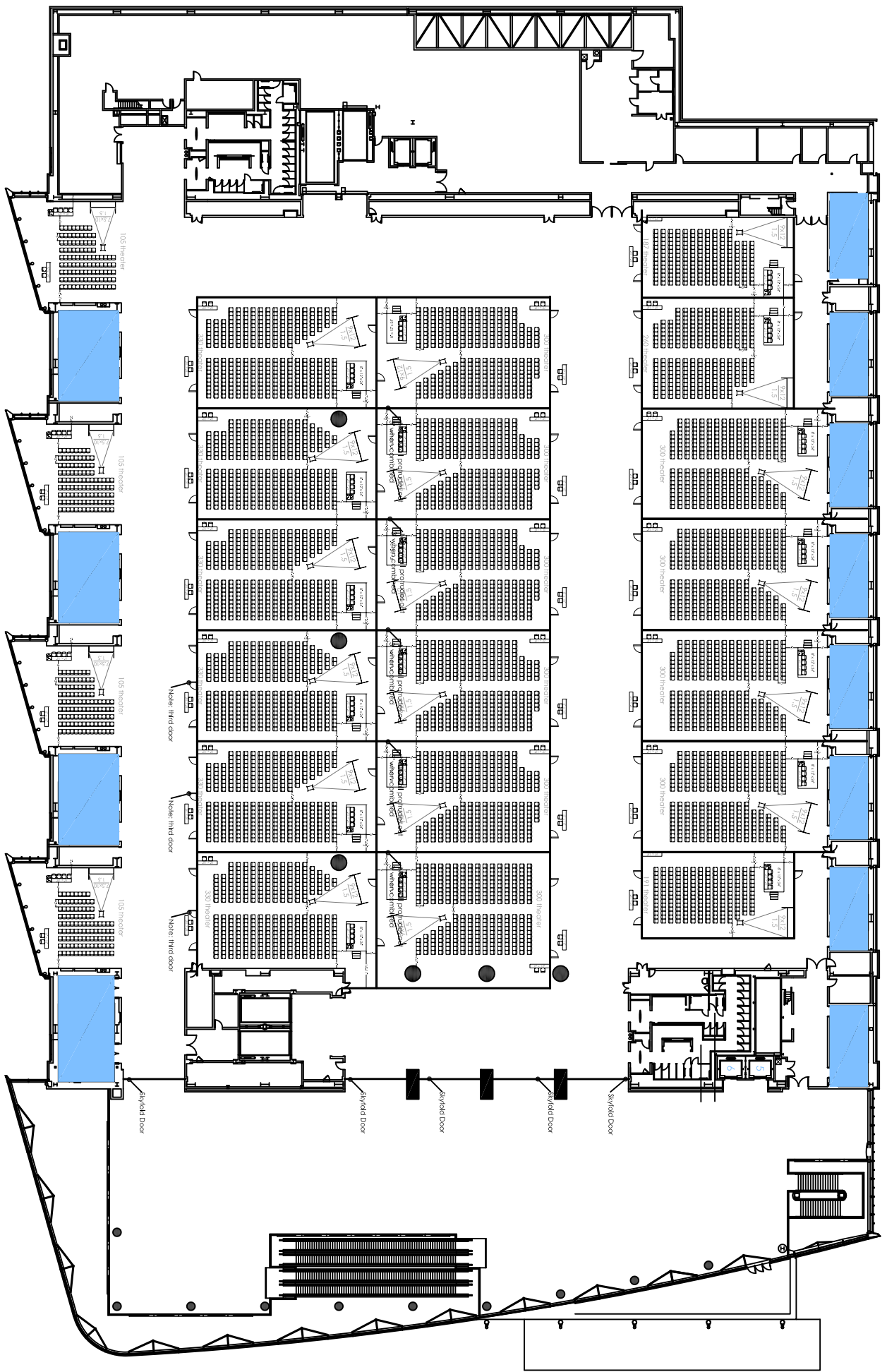

**Disclaimer:**  
This drawing is intended as a guide only.  
The Moscorne Center/SMG cannot be held  
responsible for on-site variations or  
adjustments.





West Level Three  
Banquet

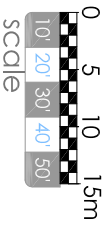

Level 3 Floor Load:  
125 lbs per square Foot

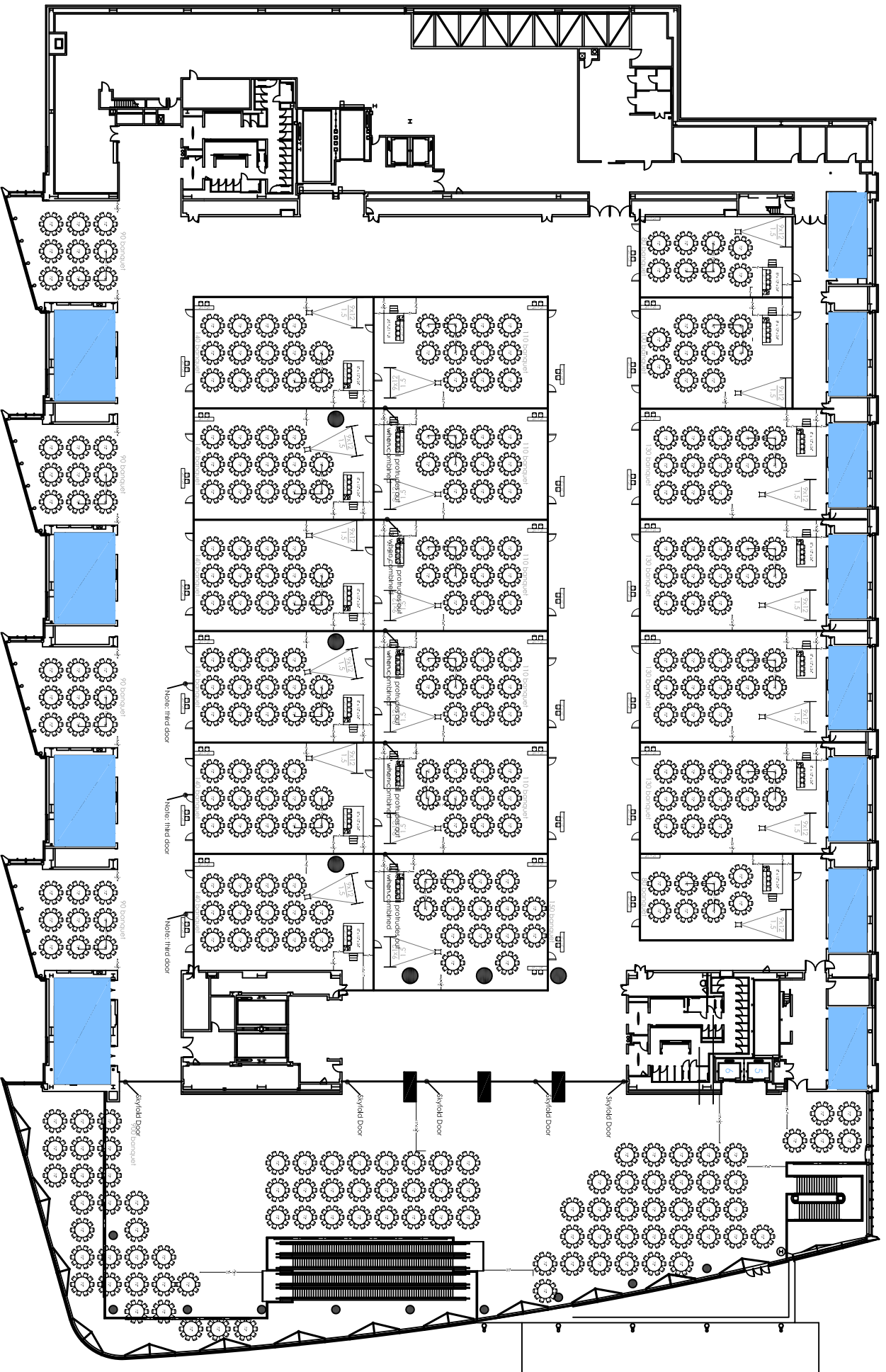

**Disclaimer:**  
This drawing is intended as a guide only.  
The Moscone Center/SMG cannot be held  
responsible for on-site variations or  
adjustments.



West Level Three  
Classroom

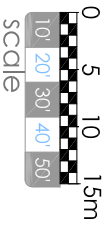

Level 3 Floor Load:  
125 lbs per square foot

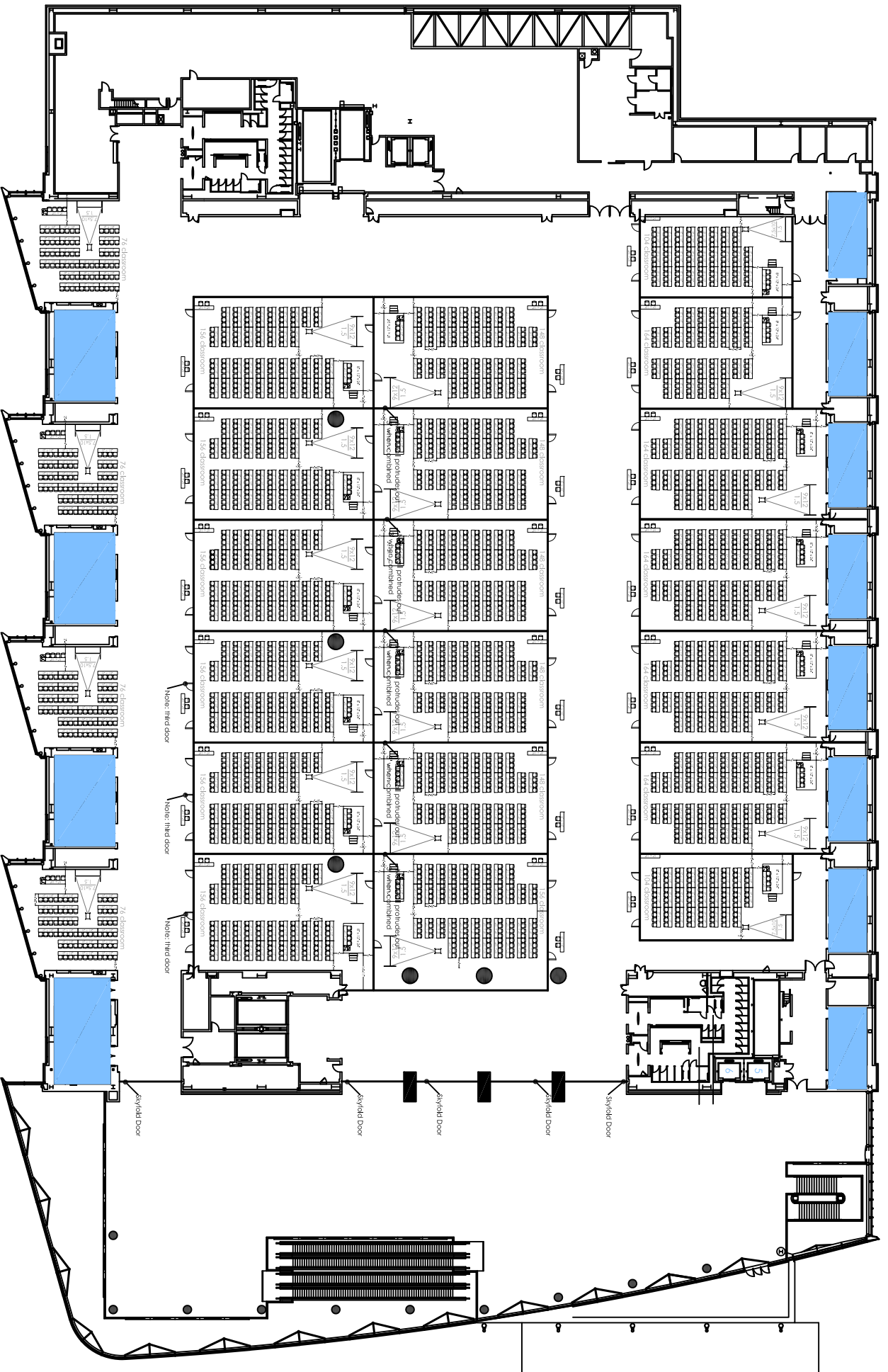

**Disclaimer:**  
This drawing is intended as a guide only.  
The Moscone Center/SMCG cannot be held  
responsible for on-site variations or  
adjustments.