



Shuttles Drop-Off
Howard Street



Level One

This drawing is intended as a guide on The Moscone Center/SMG cannot be held responsible for on-site variations
adjustmer



Shuttles Drop-Off Howard Street

Mirna Street

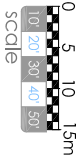
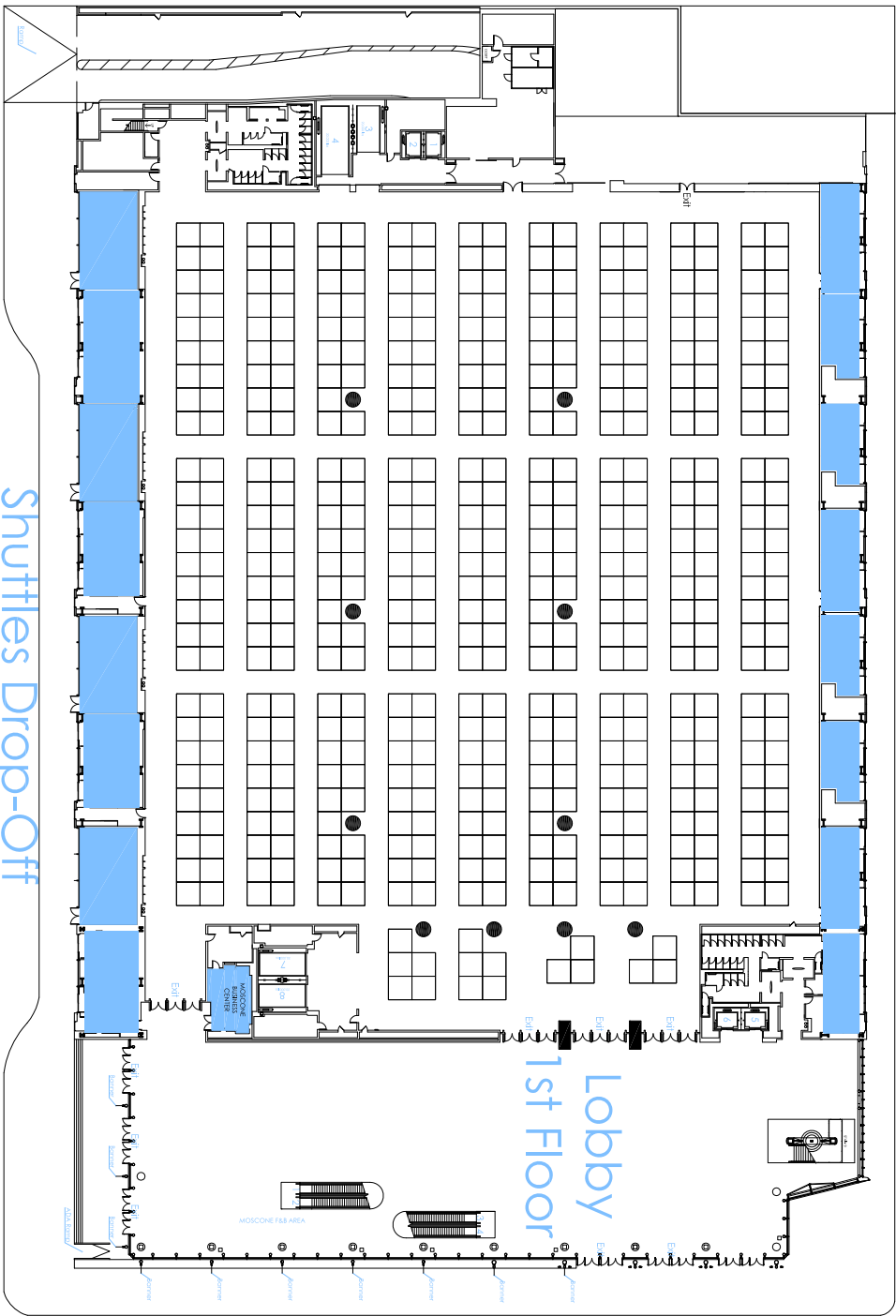

Booth Inventory as of 02/21/2021				
M/C West Level 1 Booths				
Level 1 - 496 Booths				
0% - 0 SqFt Rented				
100% - 49,600 SqFt Available				
Dimension	Size	Qty	SqFt	Rented
10x10'		100	496	0
Totals:		496	49,600	0



West Level 1 | Rigging

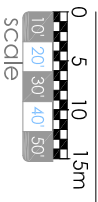

NOTES:
- RIGGING EYEBOOT POINTS ARE RATED AT 5000LBS
- VERTICALLY DOWNWARD
- HEIGHT FROM FLOOR TO BOTTOM OF EYEBOOT = 28"

10' 20' 30' 40' 50'

scale

Shuttles Drop-Off Howard Street

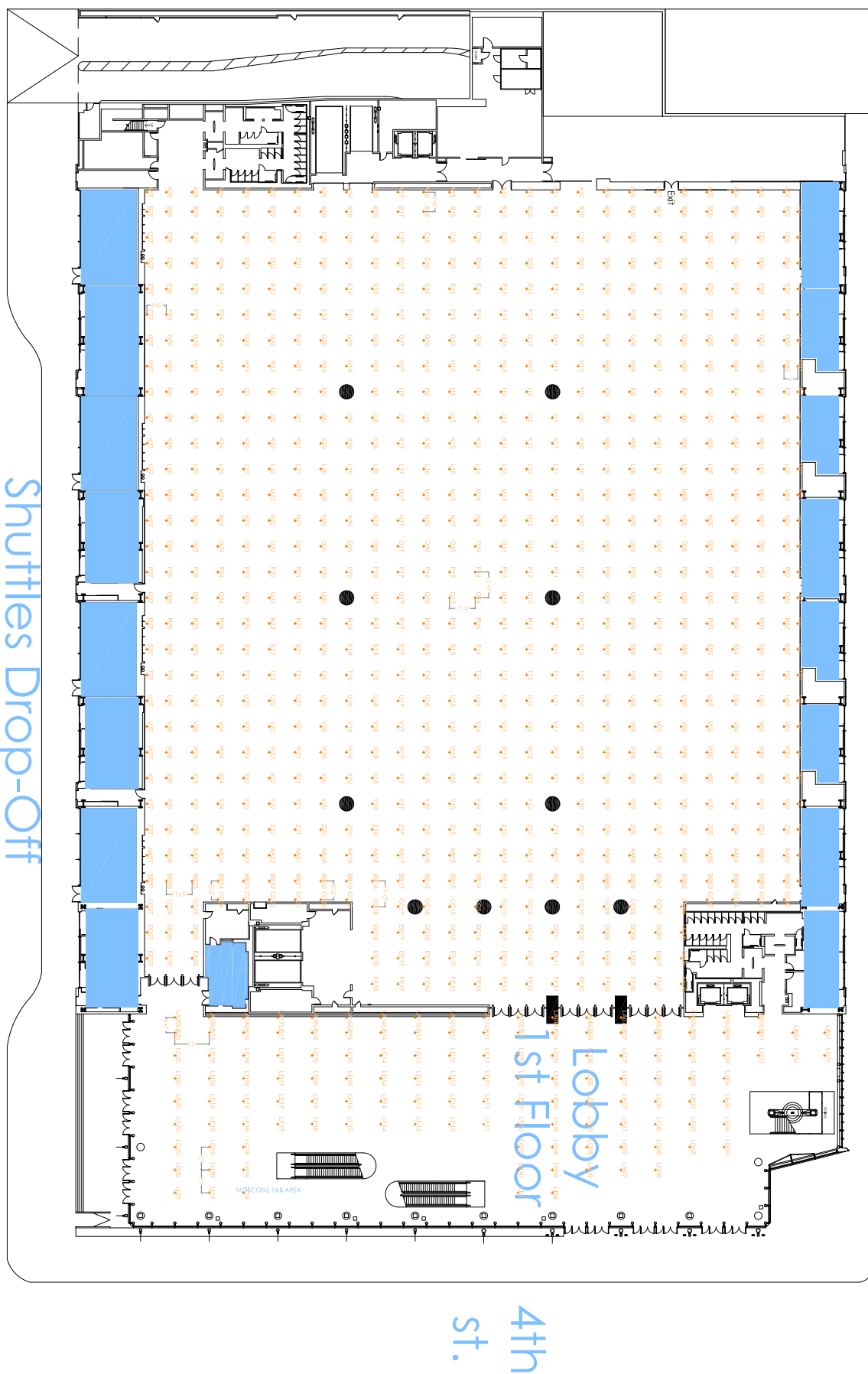

Mirna Street

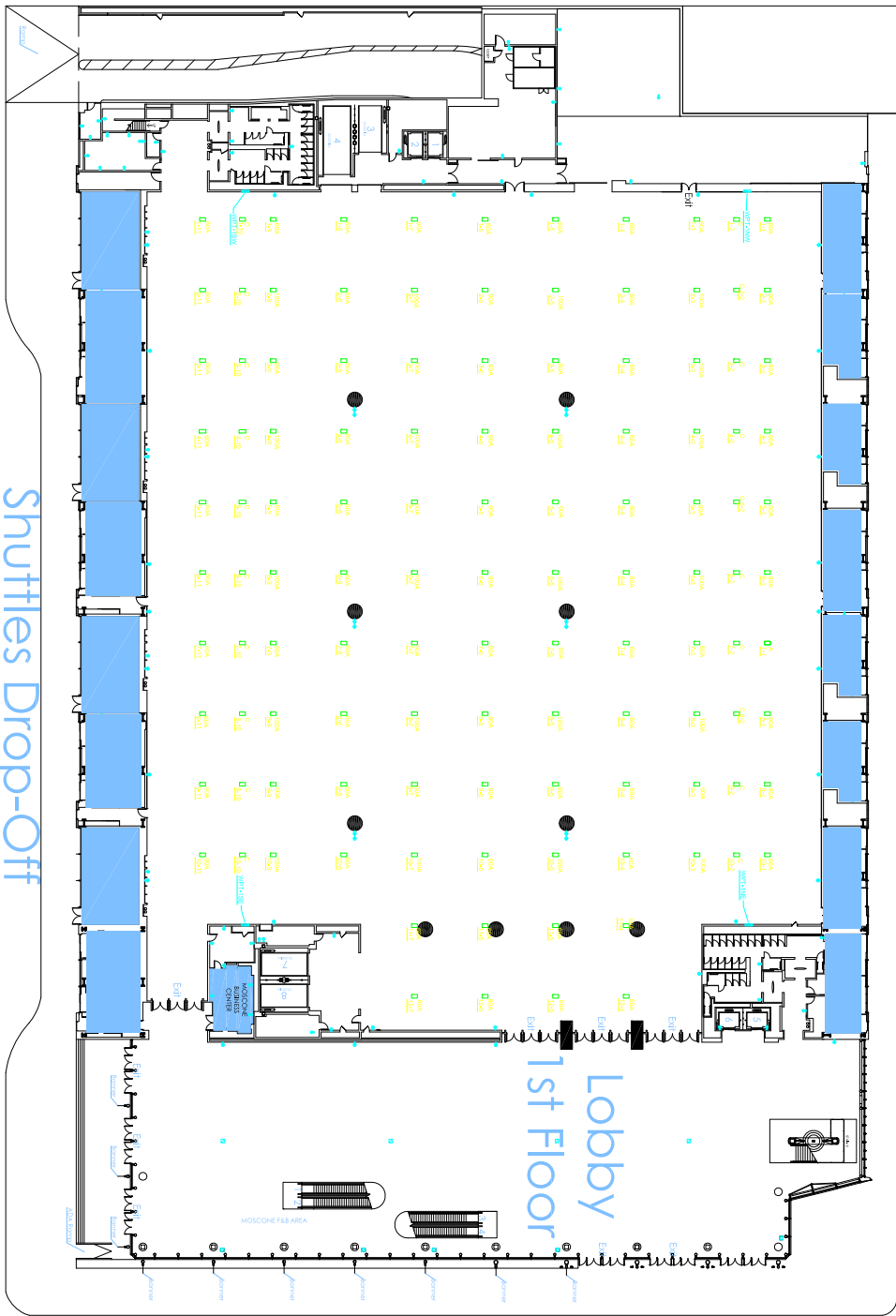

Shuttles Drop-Off
Howard Street

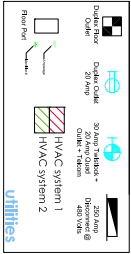
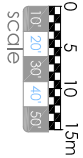

West
Level One | Utilities



Disclaimer: This drawing is intended as a guide on The Moscone Center/SMG cannot be held responsible for on-site variations